



Student Quick Start Guide

Respondus LockDown Browser + Monitor

What is Respondus LockDown Browser + Monitor?

Respondus is a locked down browser used when taking Fisdap proctored assessments. It prevents students from copying, printing, visiting another URL, or accessing other applications during a test. If a Fisdap test requires the LockDown Browser to be used, students cannot take the test with a standard web browser. The Monitor records the student during the exam. The record will only be reviewed if there is a reason to believe the test protocol has been breached.

System Requirements for Students

Windows: 10 or 11

Mac: macOS 10.15 to 14.0+

ChromeOS: LockDown Browser for Chromebook minimally requires the version of ChromeOS that Google makes available via their Long Term Support (LTS) channel. For more information, visit: Chrome Releases: [LTS](#)

Important for Chromebook Users:

- To install the LockDown Browser extension, use the regular LockDown Browser installation link provided by your school. This link will direct you to the Chrome web store, where you should select "Add to Chrome" to install the extension. Note that you cannot search for the app directly from the Chrome web store.
- Managed Chromebooks: Students will need the necessary permissions to install Chrome extensions, or the extension will need to be pushed to their Chromebooks via the Google Admin Suite.

iOS: 15.0+ (iPad only)

- Web camera (internal or external)
- Microphone (internal or external)
- An internet connection of at least 5 Mbps (ideally 10 Mbps or more). Test internet speed using <https://www.speedtest.net/>
- Administrator rights are needed to install Respondus. If device is managed by school, please reach out to IT administrator to have Respondus installed.

Set Yourself Up For Success

- Ensure you are using a fully charged laptop or desktop computer
- Check to see if your camera works in Chrome using <https://webcamtests.com/>
- Check to see if your microphone works in Chrome using <https://www.onlinemictest.com>
- Internet speed of at least 5 Mbps (ideally 10 Mbps or more). Test internet speed using <https://www.speedtest.net/>
- Have a school or government-issued ID card available
- Find a well-lit space and be ready for a desk scan prior to the assessment
- One piece of blank paper can be used during assessment. Please destroy the paper upon completion of the exam

Taking a Test

Close all programs except for an internet browser.

IMPORTANT: To access your assessment, you must log into Fisdap (<https://fisdap-members.jblearning.com/login>) through an approved browser. Respondus will open automatically when you launch the test. You cannot access the test directly through the Respondus LockDown Browser or from another LMS.

Go to the Learning Center. The available proctored assessment will be listed under Secure Testing. Click on the name of the assessment to launch.

You will be prompted to open the Respondus LockDown Browser + Monitor. Open the link. If any other windows or applications are open, they will close automatically.

iPad users: You will be required to lock in the orientation of the iPad before beginning the exam. Please prop the iPad vertically so that it faces you. We recommend using a case or stand and external keyboard, if you own one. Do not lay the iPad on a flat surface.

Mac/Windows users: If your testing window does not show on the full screen, this may be related to display settings on your computer. For high resolution monitors, try changing your display settings to 3840 x 2160 resolution using 200% scaling.

1. You will see nine steps to complete before beginning your exam. First, agree to the Student Terms of Use.

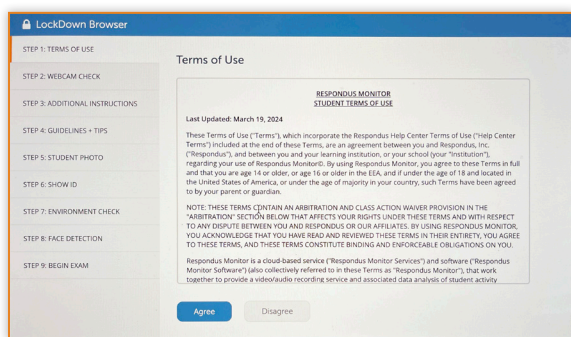

2. Complete your webcam check. You will be asked to record a five-second video to ensure your audio is working appropriately. *This video will not be stored.*

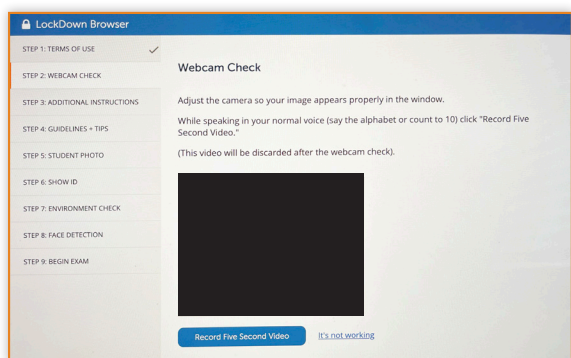

3. Click 'Next' to move through the additional instructions, guidelines, and tips.
4. You'll be asked to take two photos of yourself. This will be used to compare to your identification.

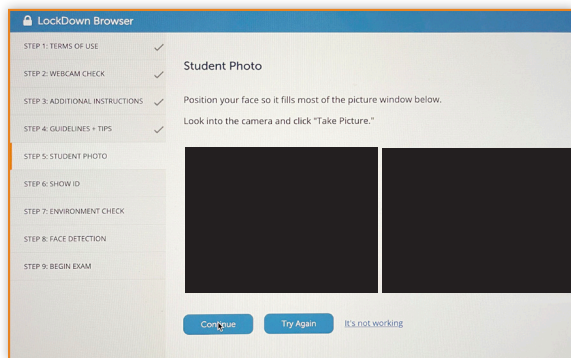

5. You will need to capture a picture of your student or government-issued ID. Acceptable government-issued ID includes state issued driver's license, state issued identification card, military identification card, or passport.

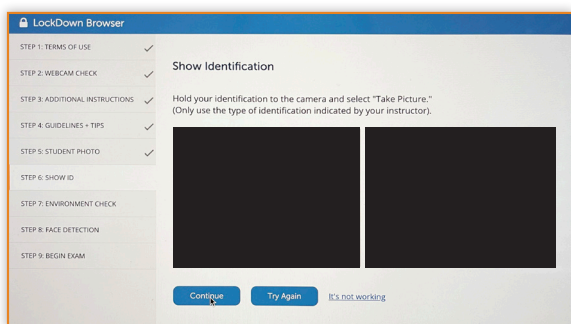

6. You will be asked to show your exam environment. Slowly move your device so that it shows the area around your computer. This is to ensure there are no papers, phones, or books that could be used to provide answers during your exam.

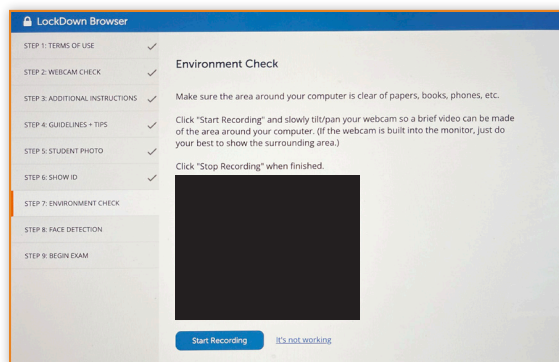

7. To ensure your webcam is working sufficiently, you will do a facial detection check.

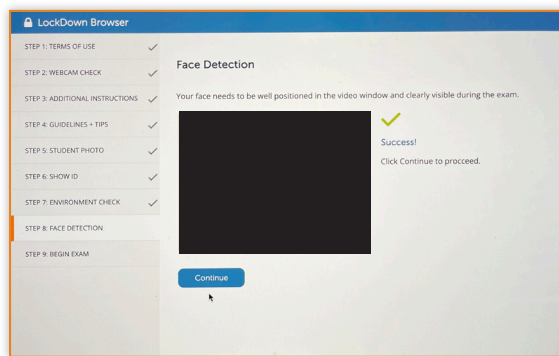

8. Click 'Begin Exam'.

Once you complete your exam, a message will appear telling you the webcam recording is complete. You will be asked about your experience using the Respondus LockDown Browser + Monitor. Once your comments are submitted, you will need to select 'CLOSE BROWSER'. Open a new internet browser window and log back into the Fisdap student portal to review your exam results.

Need Support?

- If you experience technical difficulties, please contact Fisdap Support at support@fisdap.net for assistance.
- Please note that if you are taking an exam outside of Fisdap Support hours, live assistance will not be available.
- Find the answers you need in our Support section by visiting <https://www.fisdap.net/support>

